

# Padded Chair Seat Cushion

## Materials:

- 1 7/8 yard 44" wide fabric
- 1 inch thick cushion foam slab 18"x30"

## Cutting Instructions:

- Cut 2 pieces fabric 20"x32"
- Cut 1 piece fabric 20"x17"
- Cut 1 piece 10 1/2" x 2 1/2"
- Cut 1" thick piece of foam 18" x 30"
- Do not substitute Batting. Much better results with foam slab.
- Use a serrated knife or an electric knife for cutting the foam

## Construction of the seat cushion:

### Handles:

Fold the 10 1/2" x 2 1/2" piece of fabric in half lengthways. Sew across one short end and down the length of the strip, keeping raw edges even as you sew. Turn right side out and press. Set aside.

### Chair back Flap/Pocket:

Fold the 20"x17" piece of fabric in half so it measures 8" X 20". Press and set aside.

## Assembling the Chair Cushion:

This is the order for the layout of the chair cushion:

1. Lay one piece of the 20"x32" fabric right side up
2. Pin the 10" x 1 1/4" piece (which is the handle) 7" in from the outside edge of the 20" side of the 20"x32" (making sure the handle is not twisted) so it looks like this:

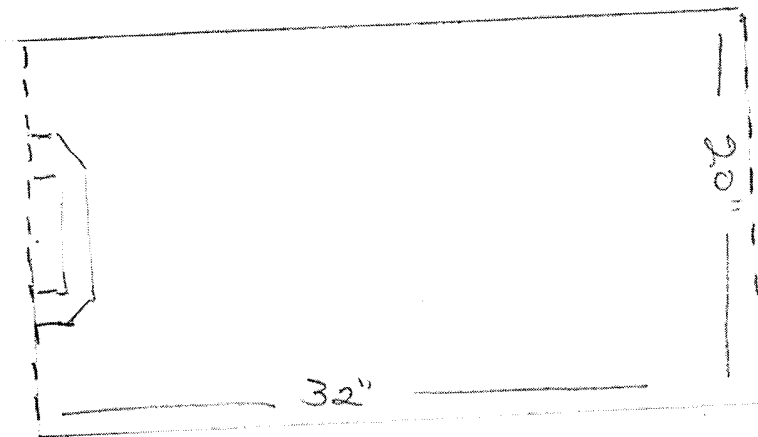

3. On top of the you will place the 8 1/2"x20" piece of fabric keeping the raw edges together and pin that in place.
4. Next you will place the last 20"x32" piece of fabric on top of this, keeping the raw edges together and pin in place.
5. Now pin all around all the raw edges keeping them together.
6. Starting at the opposite end of the handle, start sewing about 2 1/2"-3" from the outside edge, leaving a 12"-14" opening to insert the foam later. Sew on all three sides ending up with 2 1/2"-3" seam from the outside edge, so it will look like this:

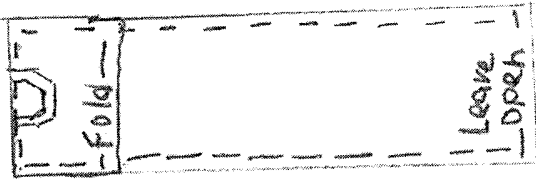

7. Turn right side out. Insert the foam piece and work it around until the foam fits well. This will take a few minutes. Hand sew the 12"-14" opening closed, or machine stitch.
8. Fold the cushion in half to find the center point and place two pins in, on each side.
9. Sew from one side across to the other side, flattening the foam with your hands as you sew on your machine. It is best if you use a larger sewing machine needle for this part.
10. Your cushion is done and ready to enjoy!!! Completed cushion should look like the drawing below. For a more secure seat cushion, add side ties at seat cushion fold line.

